



M E E T I N G S



P R I V A T E E V E N T S



HAMILTON PRINCESS

BERMUDA

HOTEL • BEACH CLUB • MARINA

The premier address for a Bermuda meeting, the Hamilton Princess is proud to offer modern facilities supported by a comprehensive array of professional and state-of-the-art services, all combined with old world splendour.

Our Catering & Conference Services Managers offer expert knowledge in planning meetings and events that are unparalleled successes.

The Hamilton Princess offers more than 29,000 square feet of indoor and outdoor meeting space, including six function rooms, that can be configured to meet your specific needs.

H A R B O U R V I E W B A L L R O O M

The Harbourview Ballroom offers 8,400 square feet of modern Bermudian elegance for any general meeting, large delegate gathering or gala event.

This state-of-the-art ballroom overlooks the beautiful Hamilton Harbour with floor to ceiling windows.

Suitable for up to 1,000 people depending on configuration.



THE PRINCESS BALLROOM

This multipurpose ballroom can be divided into three medium sized meeting or event rooms. Bordered by the outdoor Regency Terrace, these rooms are perfect for meeting breakouts, coffee, meal breaks, receptions or large events.

Suitable for up to 500 people depending on configuration.





TRUDEAU BALLROOM

The hotel's newest event space located on the Mezzanine Floor. Formerly the Fairmont Gold Lounge, this grand ballroom is an excellent location for breakfasts, lunches, cocktail receptions or events. High ceilings are adorned with chandeliers and the large windows and terrace boast views of the courtyard and harbour. Palatial columns add to making this space the perfect setting.

Suitable for up to 200 people based on configuration.

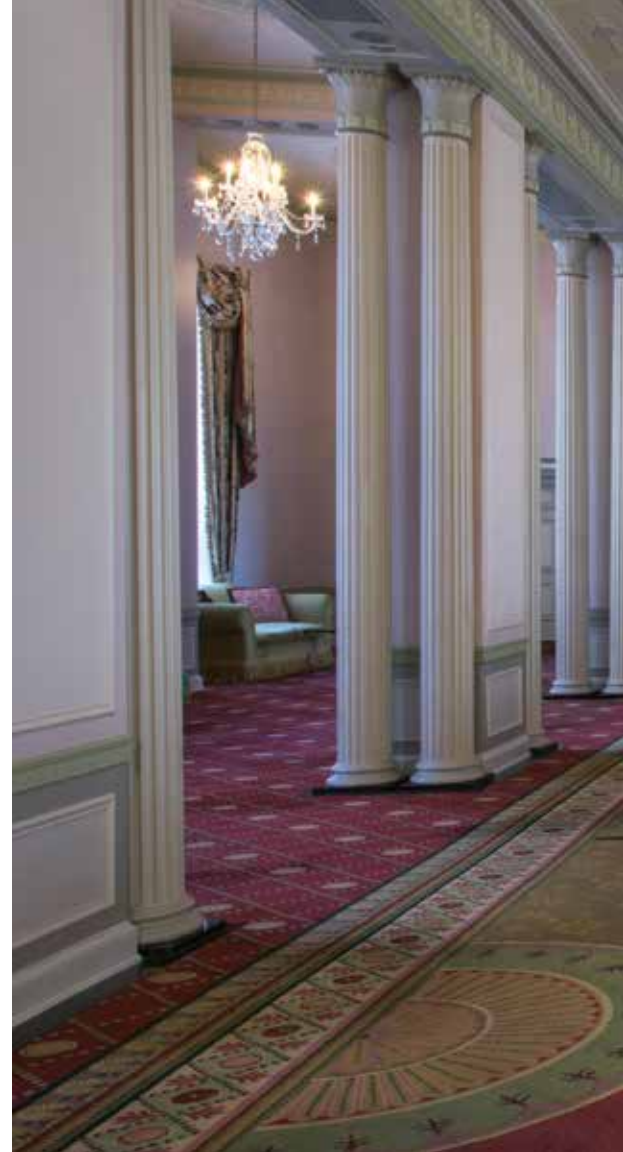





THE TWAIN BOARDROOM

The Twain Boardroom located on our Mezzanine Floor offers seating for up to 24 people and was newly renovated in 2015. With modern amenities, including built-in technology ports, this is the premium space for a formal or informal board meeting. This space can also be used as an office with the existing set up.



THE CHURCHILL BOARDROOM

Named after Sir Winston Churchill's historically famous meetings with his WW2 allies, this boardroom is located next to our Trudeau Ballroom and is well suited for small meetings. While still retaining the historical feel, this newly renovated boardroom offers the perfect bright and private space for a meeting.

Suitable for up to 16 people.



OUTDOOR MEETINGS & FUNCTIONS

Imagine your meetings and events taking place next to sparkling blue waters.

Our harbourside Regency Terrace, Flagpole Terrace and Marina provide the most beautiful outdoor settings right at the water's edge.

The terraces and Marina can accommodate up to 730 people depending on your requirements.

For smaller, more intimate meetings and functions, Pitts Bay Point at the west end of our property provides stunning views.





Marcus' striking setting, and menus created by chef Marcus Samuelsson, set a new style for dining in Bermuda. Modern art and an open kitchen with a wood burning grill add to its unique atmosphere.

Suitable for up to 40 people in the Private Dining Room or 160 in the main restaurant.



Perched right on Hamilton Harbour and named to commemorate the settling of Bermuda, 1609 Bar & Restaurant offers your guests uninterrupted sea views and provides a relaxed, open air setting for your functions.

Suitable for up to 150 people.



P R I N C E S S B E A C H C L U B

The Princess Beach Club on the South Shore in Southampton provides a serene getaway for off-site meetings and functions. A complimentary jitney is available to transport attendees to and from the Beach Club throughout the day and private jitneys are available for hire for evening events. The Beach Club offers a variety of event spaces from the actual beach club to the breathtaking plateaus overlooking the ocean.

Available for private events after 6:00pm.

Suitable for up to 700 persons depending on requirements.

BANQUET CAPACITY CHART

Room Details	Measurements		Setup and Capacity							
	Sq. Ft.	Height	Reception	Plated Rounds	Buffet Rounds	Theatre	Classroom	Boardroom	Square	U-Shape
Harbourview Ballroom	8,400	11' 10"	1000	500	420	700	320	60	100	75
The Princess Ballrooms - All	6,125	10' 3"	500	420	340	600	240	60	100	75
Princess Louise Ballroom	1,500	10' 3"	130	80	70	130	60	30	50	35
Princess Victoria Ballroom	2,000	10' 3"	225	140	120	200	120	40	60	45
Princess Katherine Ballroom	1,275	10' 3"	100	80	70	90	50	20	30	25
Trudeau Ballroom	2,799	13'	200	150	100	150	90	40	50	35
The Twain Boardroom	720	9'	N/A	N/A	N/A	N/A	N/A	24	N/A	N/A
The Churchill Boardroom	480	7' 8"	N/A	N/A	N/A	N/A	N/A	16	N/A	N/A
Regency Terrace*	3,600	N/A	350	250	210	300	N/A	N/A	N/A	N/A
Flagpole Terrace*	2,500	N/A	180	120	100	120	N/A	N/A	N/A	N/A
Marina*	5,070	N/A	200	150	100	N/A	N/A	N/A	N/A	N/A
Marcus'	4,026	15'	160	100	N/A	N/A	N/A	N/A	N/A	N/A
Marcus' Private Dining Room	259	15'	40	30	N/A	N/A	N/A	N/A	N/A	N/A
1609	3,466	N/A	150	150	80	N/A	N/A	N/A	N/A	N/A
Beach Club - Bridal Vista**	1,302	N/A	50	40	30	N/A	N/A	N/A	N/A	N/A
Beach Club - The Plateau**	75,046	N/A	700	600	500	N/A	N/A	N/A	N/A	N/A
Beach Club - Sinky Bay Beach**	30,678	N/A	300	200	200	N/A	N/A	N/A	N/A	N/A

* Requires indoor backup in hotel

** Additional transportation required

BANQUET LAYOUT MAP

Harbourview Ballroom

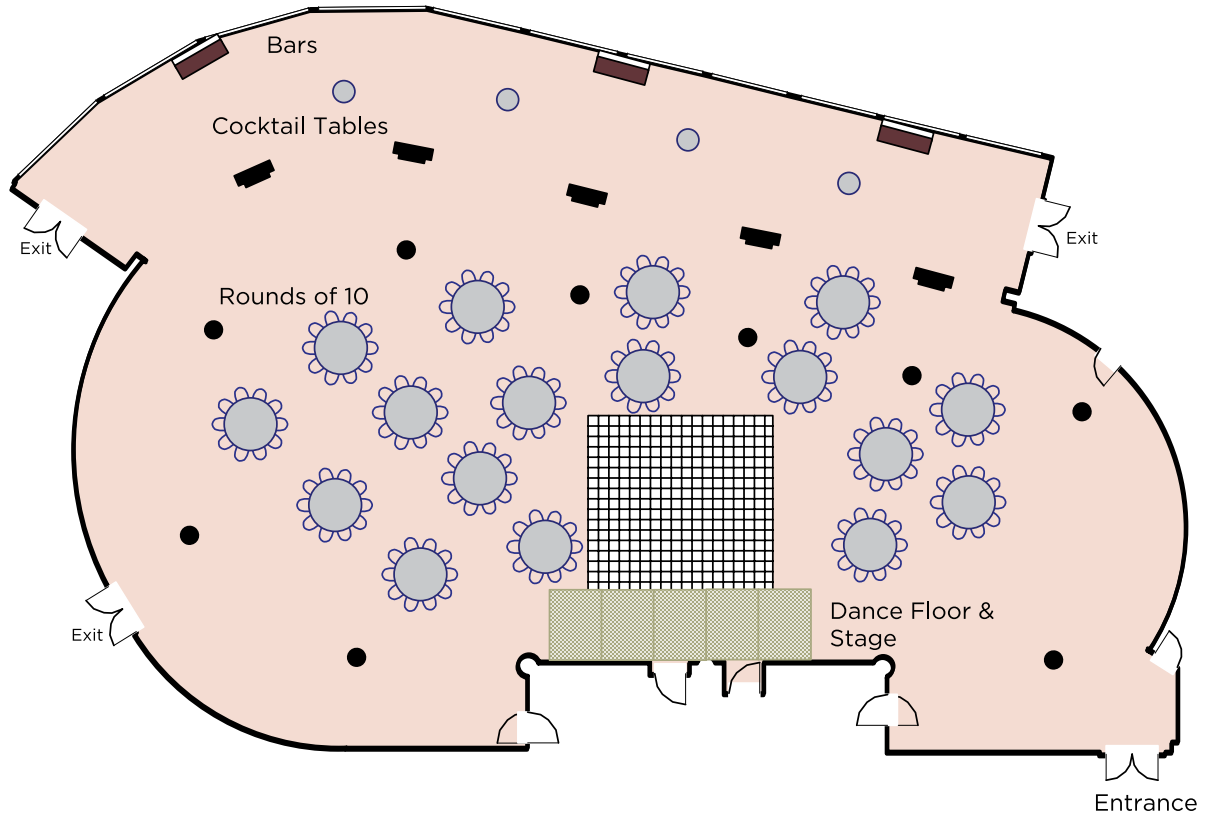

BANQUET LAYOUT MAP

The Princess Ballroom and Foyer

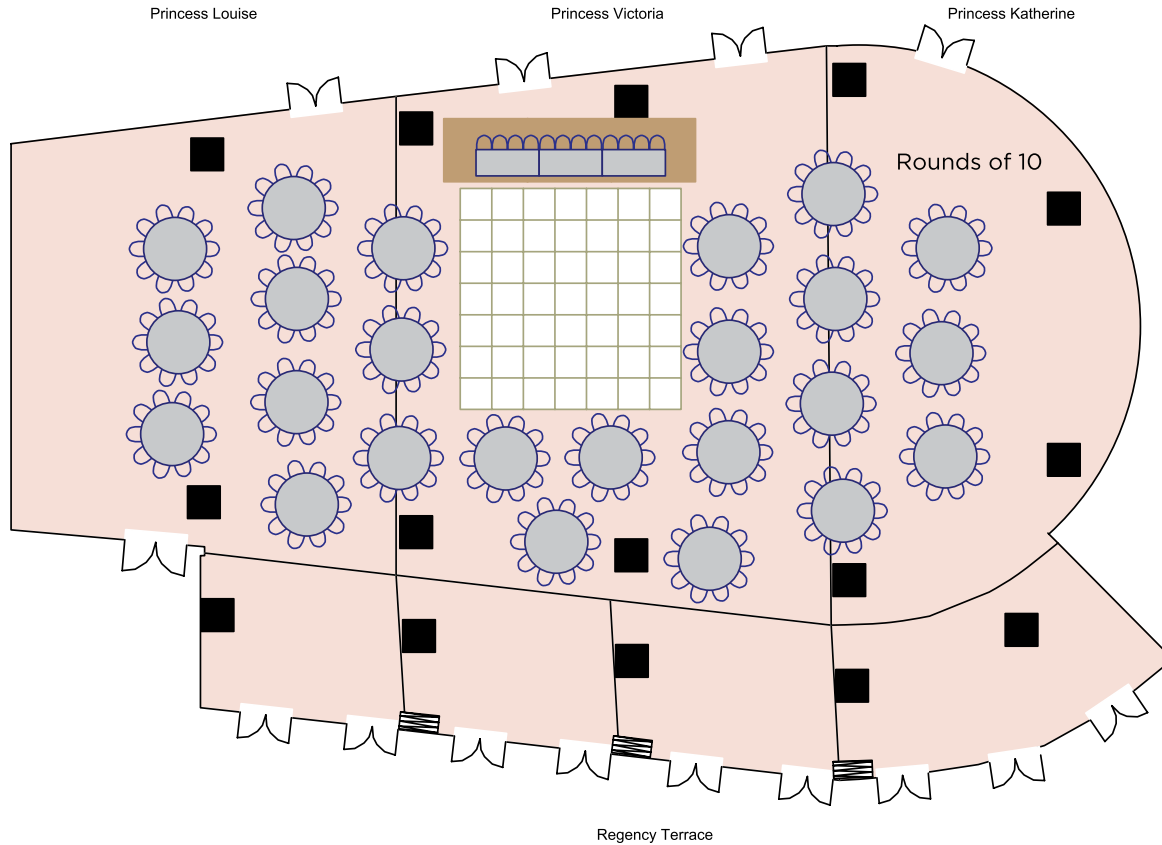

BANQUET LAYOUT MAP

Trudeau Ballroom

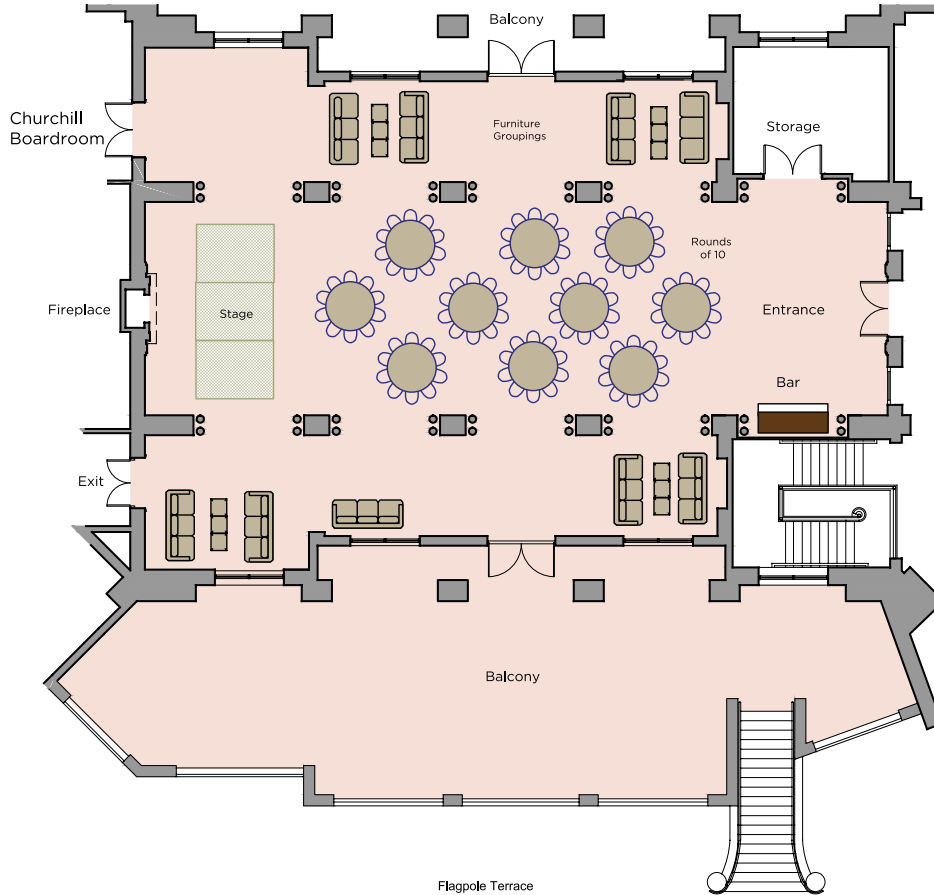

BANQUET LAYOUT MAP

The Twain Boardroom

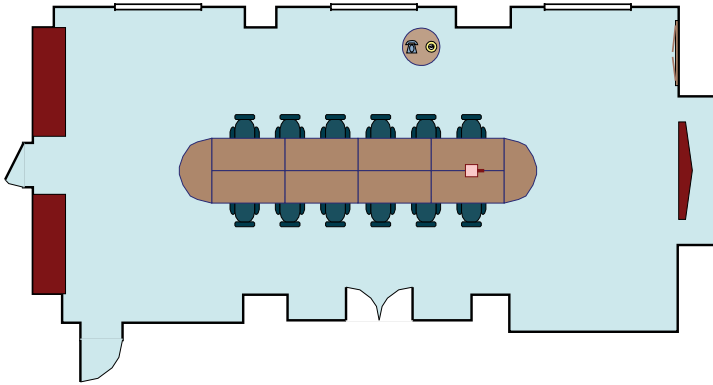

The Churchill Boardroom

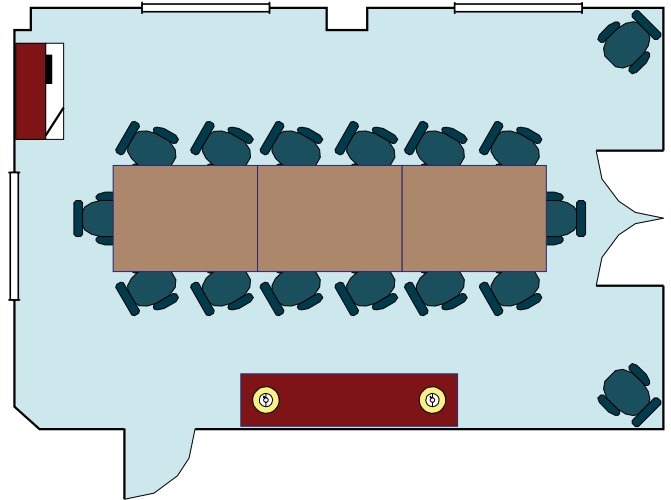

BANQUET LAYOUT MAP

Regency Terrace

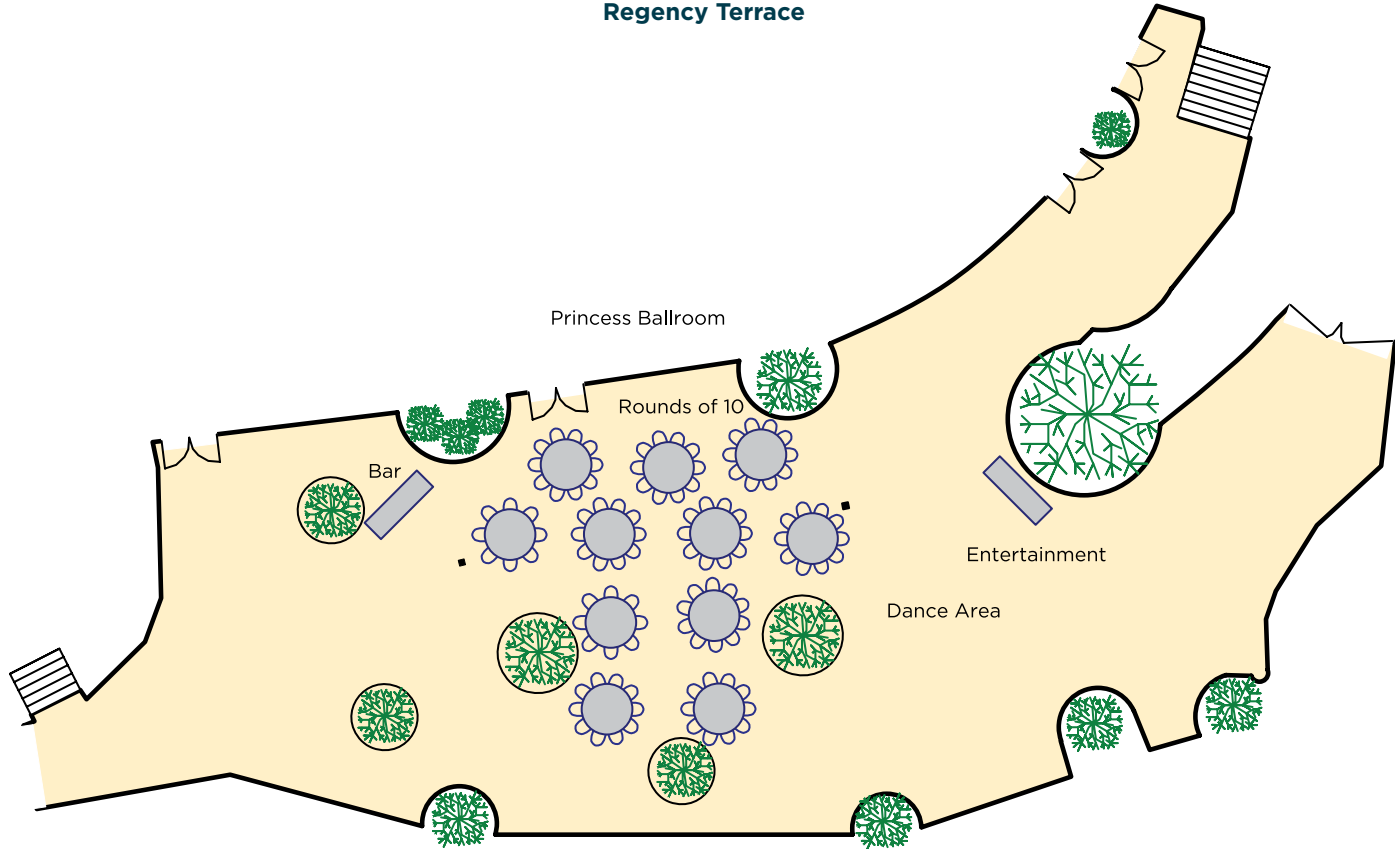

BANQUET LAYOUT MAP

Flagpole Terrace

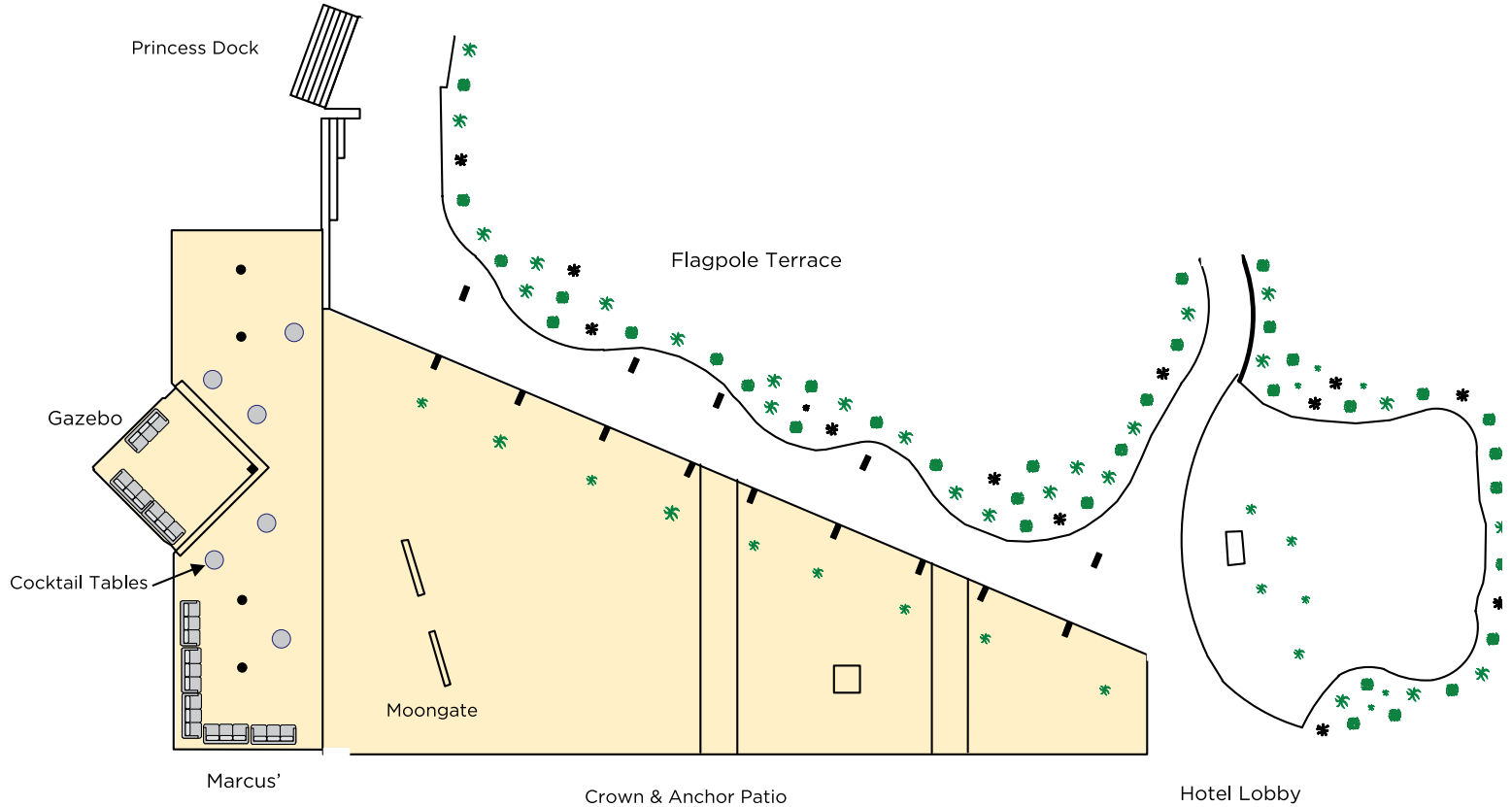

BANQUET LAYOUT MAP

Marina

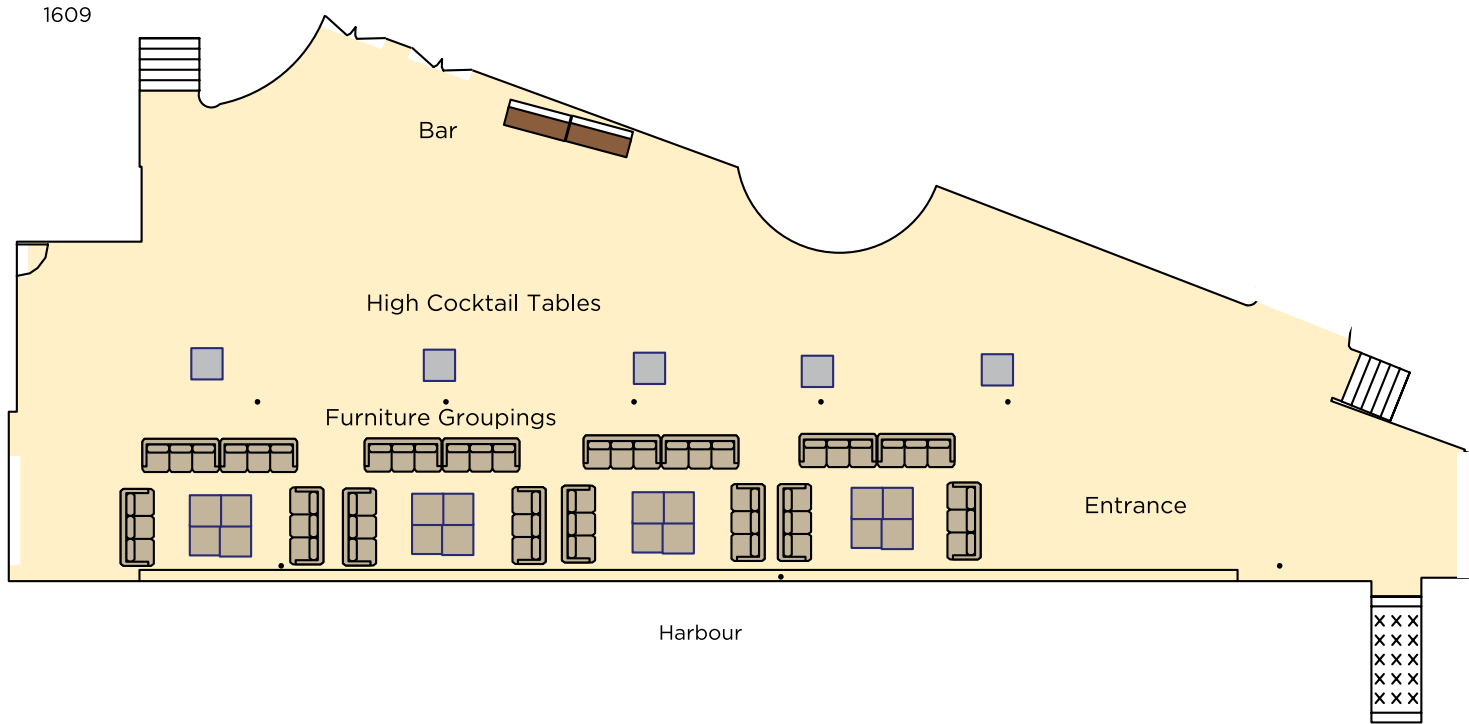

BANQUET LAYOUT MAP

Marcus' Restaurant & Private Dining Room

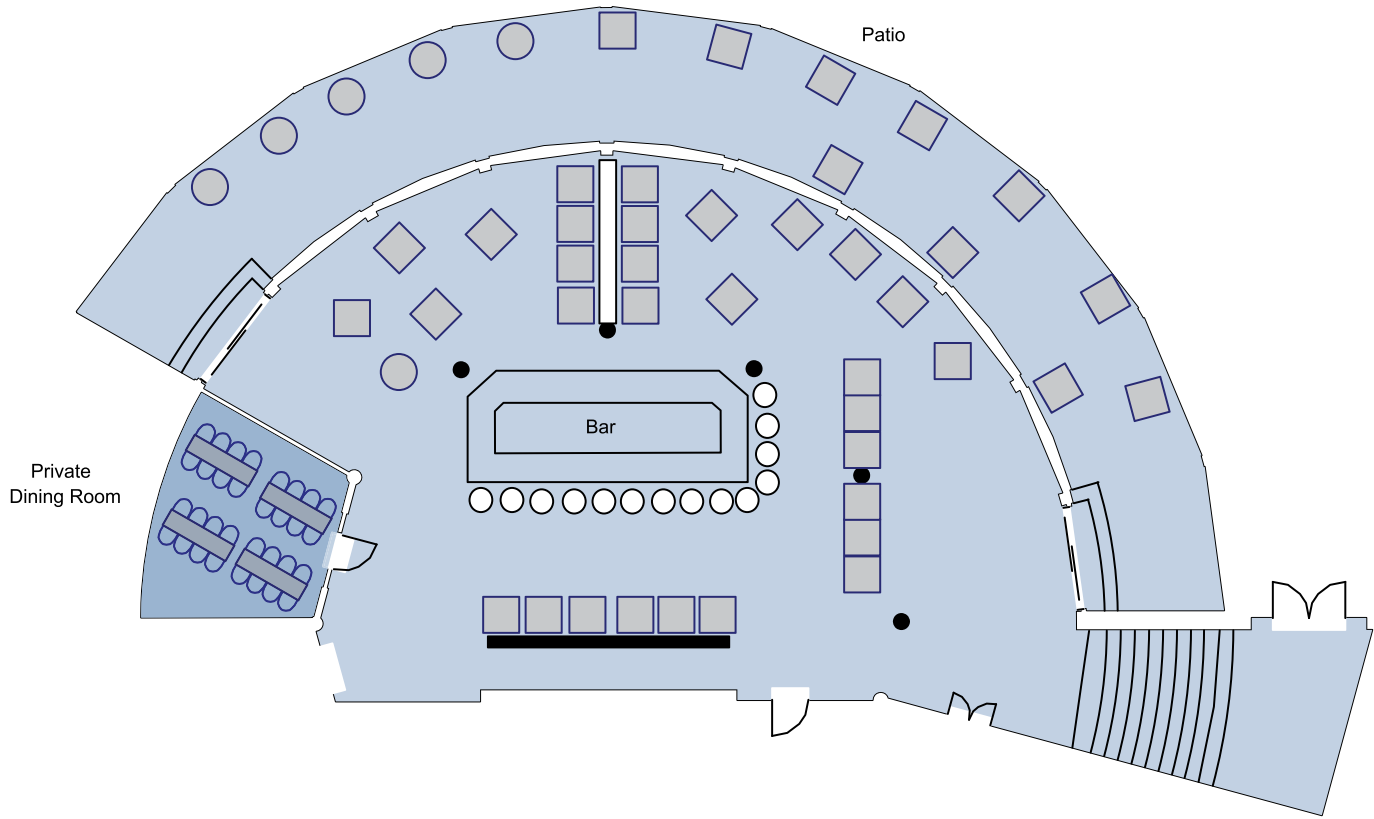

BANQUET LAYOUT MAP

1609 Bar & Restaurant

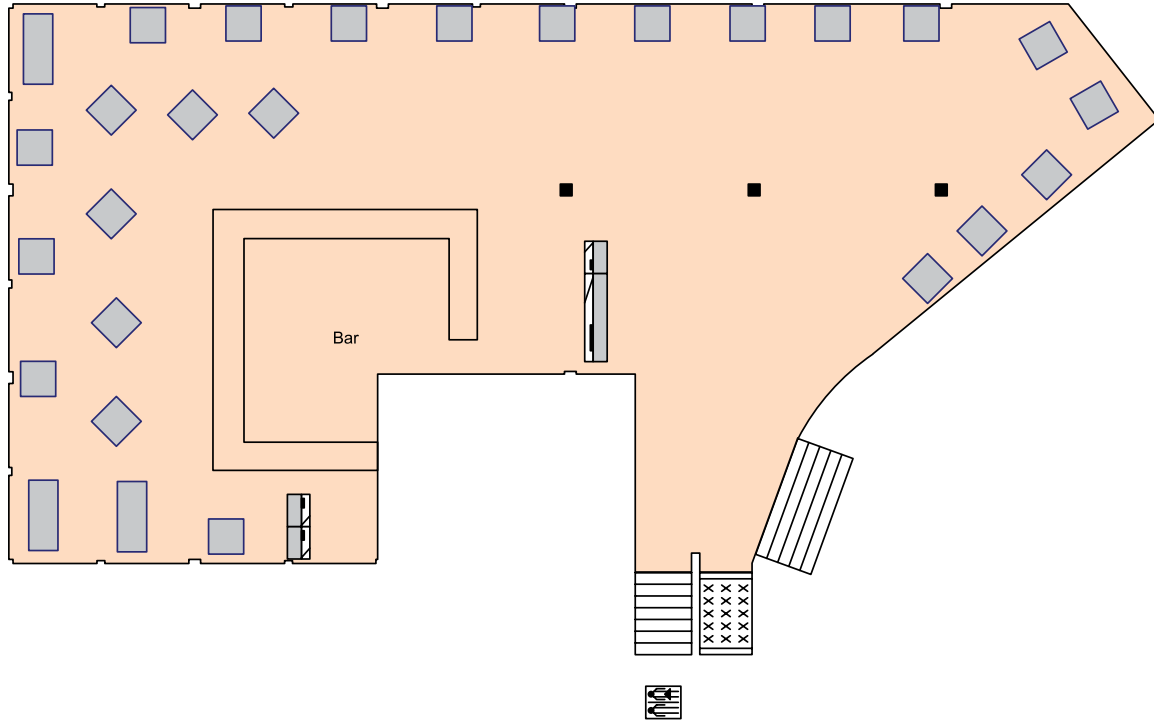

CATERING

Stay stress free and leave the hard work to us. Have the Hamilton Princess cater your off property functions and events. Please contact the Catering Team for more details and information.

AUDIO - VISUAL REQUIREMENTS

Please ask your Catering or Conference Services Manager for information regarding our state-of-the-art audio-visual services.



For more information and to book your meetings, please contact:

T: 441-295-3000

E: ham.events@fairmont.com

or visit www.fairmont.com/hamilton

