



THE *Fairmont*
CHATEAU WHISTLER

NESTLED AT THE BASE OF
MAJESTIC BLACKCOMB MOUNTAIN

Spectacular alpine elegance

Whatever the season, an unforgettable experience awaits you in Whistler. In summer, soaring mountain peaks, lush valleys and serene glacial lakes host a world of unrivalled hiking, mountain biking, canoeing and golf. Winter presents an equally inspiring wonderland, with world-renowned skiing and snowboarding, as well as snowshoeing, horse-drawn sleigh rides and more. The European-inspired village will entice you with its unique shops and restaurants, lively cafés and nightspots. At the heart of this unique experience is The Fairmont Chateau Whistler — the true definition of Canadian mountain luxury. Whether you're here for business or for complete relaxation, The Fairmont Chateau Whistler's outstanding offerings ensure that every stay becomes a cherished memory.



GUEST ROOMS AND SUITES

The Fairmont Chateau Whistler's 550 guest rooms and suites embody the resort's signature alpine comfort and luxurious decor. Every room offers a wealth of amenities, always complemented by our staff's warm, engaging service.

Room and suite selections

- Fairmont Room
- Deluxe View Room
- Deluxe Slopeside View Room
- Junior Suite
- One- and Two-Bedroom Suites
- Luxury One-Bedroom Mountain View Suite

Guest room amenities and features

- Down-filled duvets
- Thick bathrobes
- In-room safes
- All rooms non-smoking
- High-speed wireless Internet access
- Pet-friendly rooms
- On-command movies and video checkout
- Individual heat and air-conditioning controls
- Windows that open for fresh mountain air
- Coffee maker/kettle
- Le Labo amenities

FAIRMONT GOLD

Welcome to a world apart. Fairmont Gold, our exclusive lifestyle hotel experience, brings special privileges and an elevated level of comfort—from indulgent bath products in Gold Rooms to complimentary cocktail-hour canapés in the elegant private lounge. For business and leisure travellers alike, Fairmont Gold ensures that every expectation is not only met, but also exceeded.

Fairmont Gold room and suite selections

- Fairmont Gold Room
- Fairmont Gold Junior Suite
- Fairmont Gold One-Bedroom Suite
- Fairmont Gold Premier Suite
- Fairmont Gold Executive Suite
- Fairmont Gold Penthouse Suite

Fairmont Gold features

- Access to the exclusive Fairmont Gold Lounge and honour bar
- Dedicated Fairmont Gold Concierge team
- Express check-in and checkout
- Complimentary cocktail-hour canapés
- Complimentary deluxe continental breakfast

SPA AND HEALTH CLUB

Vida Spa

At Vida Spa—an oasis of serenity, comfort and elegance—experienced therapists use a holistic approach to blend the ancient principles of Ayurveda with modern education and practices. Enjoy a custom pampering, which emphasizes healing and health, in one of 15 full-service treatment rooms.

Services include:

- Facials
- Body massages (including Ancient Lava Rock Massage)
- Specialty body treatments, wraps and exfoliations
- Manicures and pedicures.

Health Club

Recharge and unwind in our slopeside Health Club—all while enjoying stunning views of Blackcomb Mountain. Complimentary access is provided to all Fairmont guests.

The club features:

- Indoor and outdoor pools, including an 18-metre (60-foot) heated outdoor lap pool with underwater music
- Sauna, steam rooms and 4 whirlpools (3 outdoor, 1 indoor)
- Fully equipped fitness room, with flat-screen televisions, floor-to-ceiling windows and personal trainers
- 2 outdoor Plexipave-surfaced tennis courts.

DINING CHOICES AT

THE FAIRMONT CHATEAU WHISTLER

Dining options at The Fairmont Chateau Whistler present authentic, fresh menus and unique experiences.

The Wildflower: A tantalizing showcase of locally inspired dishes and innovative favourites in a warm and relaxed setting. Enjoy classic style, morning or evening.

The Grill Room: An experience beyond the traditional steakhouse, The Grill Room features a rich collection of Canada Prime beef dishes, fresh seafood and local, organic ingredients to create an unforgettable evening of fine dining.

Tea at The Fairmont: Set in the comfort of the Mallard Lounge, a new afternoon-tea tradition awaits. Relaxed and inviting, this alpine tea transcends time, cultures and, most of all, your expectations.

The Mallard Lounge and Terrace: Playful martinis and decadent desserts abound at this popular destination. Enjoy light fare, sample fine scotches and stargaze, all in the comforting glow of roaring fire pits.

Portobello Market and Fresh Bakery: Portobello's hip and lively setting serves up a fresh and fabulous deli-style menu.

The Chalet: With its enchanting fireside ambience, The Chalet is a warm and welcoming winter haven for evening fondue dining. (Open from mid-December to mid-March.)

Clubhouse Terrace: A memorable day of golf deserves an equally endearing finale. Enjoy relaxed dining on the outdoor patio. (Open from May to October.)

The Woodlands Rooftop Terrace: As a group-function area, the terrace is ideal for summertime events. It features a manicured herb garden and a large, heated marquee tent—complete with lighting and sound systems—that can accommodate up to 600 guests.

images from left to right

FAIRMONT GOLD EXECUTIVE SUITE, MACDONALD BALLROOM



WINTER ACTIVITIES

Whistler's transformation into a winter wonderland is nothing short of magical, making The Fairmont Chateau Whistler the ideal winter holiday destination.

The finest ski resort on the continent

Exhilarating winter adventure awaits you, with ski-in/ski-out access just steps from your door. Rated #1 in North America for over a decade, Whistler and Blackcomb Mountains' 3,280 hectares (8,100 acres) of unbelievable ski and snowboard terrain — including 200 marked trails, 16 alpine bowls and three glaciers, as well as 37 lifts — promise to thrill skiers and snowboarders of all levels. Located at the base of Blackcomb Mountain, Fairmont's Ski Valet provides on-site assistance for added convenience.

Other winter adventures

- Bald-eagle tours
- Bungee jumping
- Cross-country skiing
- Cat skiing
- Heli-skiing
- Family Tube Park
- PEAK 2 PEAK Gondola
- Horse-drawn sleigh rides
- Ice climbing
- Ice-skating
- Indoor climbing centre
- Squamish Lil'wat Cultural Centre
- Snowmobile tours
- Snowshoeing
- Zipline adventures

SUMMER ACTIVITIES

Summer in Whistler brings warm weather, brilliant sunshine, and endless opportunities to enjoy the spectacular beauty of the mountains and valleys.

The Fairmont Chateau Whistler Golf Club

Designed by Robert Trent Jones, Jr., The Fairmont Chateau Whistler's par-72, 18-hole course provides a golf experience unlike any other. Carved out of the Coast Mountain Range, with elevation changes of more than 122 metres (400 feet), this spectacular course offers unparalleled views of Whistler and the surrounding mountains, dramatic rock faces, mountain ledges, ravines, waterfalls and abundant wildlife. Fairmont's Golf Valet service includes secure storage, as well as transfer of your clubs to and from The Fairmont Chateau Whistler Golf Club.

Other summer adventures

- ATV, 4x4 and Hummer tours
- Bear-viewing tours
- Biking and mountain-bike descents
- Boating — paddleboats, canoes, kayaks, whitewater rafting, jet boats
- Bungee jumping
- Fishing
- Flightseeing — float plane or glider plane
- Frisbee golf and mini-putt
- PEAK 2 PEAK Gondola
- Horseback riding
- Hiking
- In-line skating
- Rock climbing
- Tennis (2 outdoor courts)
- Zipline adventures

HOST MOUNTAIN RESORT FOR THE 2010 OLYMPIC GAMES

The vibrant energy and spirit of the 2010 Olympic and Paralympic Winter Games lives on in Whistler. Guests can now live out their own Olympic dreams: the Whistler Sliding Centre offers bobsled and luge, while Whistler Olympic Park features ski jumping and a Nordic-sports activity centre. Both new venues are unique additions to Whistler's rich, authentic tapestry.

EXPLORING WHISTLER

Whistler's pedestrian-only areas create the perfect setting for relaxed exploring, where most everything is accessible by foot or the free Village Shuttle. The Fairmont Chateau Whistler is located in the prestigious Upper Village, a casual stroll away from the main Lower Village.

In total, Whistler offers:

- Over 90 restaurants
- More than 150 retail shops
- 15 parks, totalling 551 hectares (1,362 acres)
- 5 major lakes
- 35 kilometres (22 miles) of valley trail.

WHISTLER SNOWFALL

20-year average	metres	feet
Valley	4.30	14
Alpine	10.22	33.5

AVERAGE

TEMPERATURES (Fahrenheit/Celsius)	high °C/°F	low °C/°F
Winter	3/37	-8/18
Summer	27/80	9/48

GENERAL INFORMATION

- Time zone: Pacific Standard Time
GMT/UTC -8:00 hours
- Currency: Canadian dollar (CAD)
- Taxes: 2% room tax
12% Harmonized Sales Tax (HST)

images from left to right

SKIER, THE FAIRMONT CHATEAU WHISTLER GOLF COURSE, SLOPESIDE POOL

MEETINGS AND EVENTS

The Fairmont Chateau Whistler unites business and pleasure — 3,000 square metres (32,000 square feet) of world-class facilities married with the scenery and activities of a stunning mountain location. Whether you're organizing a seminar for 10 or a conference for 1,000, we're committed to exceeding your expectations and making your event a success. Our flexible function space includes three divisible grand ballrooms, intimate meeting rooms and unique suites.

CONFERENCE SERVICES

Our conference and meeting services feature the latest multimedia capabilities, high-speed wireless Internet access, and attentive, experienced staff to ensure that no detail will be overlooked. At The Fairmont Chateau Whistler, you can focus on what's really important: getting down to business.

CATERING SERVICES

Creating delectable feasts for groups of 10 to 1,000, our Banquet Department and renowned culinary team of award-winning chefs present fresh and inspired menus. Whether it's a gala dinner in the ballroom, a four-diamond feast at Lost Lake Park or a picnic on a glacier, it's always served with classic Fairmont flair.

AWARDS AND ACCOLADES

#1 Golf Resort in Canada and
#1 Ski Resort in Canada
Condé Nast Traveler Readers' Poll

Top 20 Family-Friendly Resorts
in Continental U.S. and Canada
Travel + Leisure Magazine

Best of the Best International
Golf Resorts
Robb Report

Best Overseas Ski Resort
(Gold List Awards)
Luxury Travel Magazine

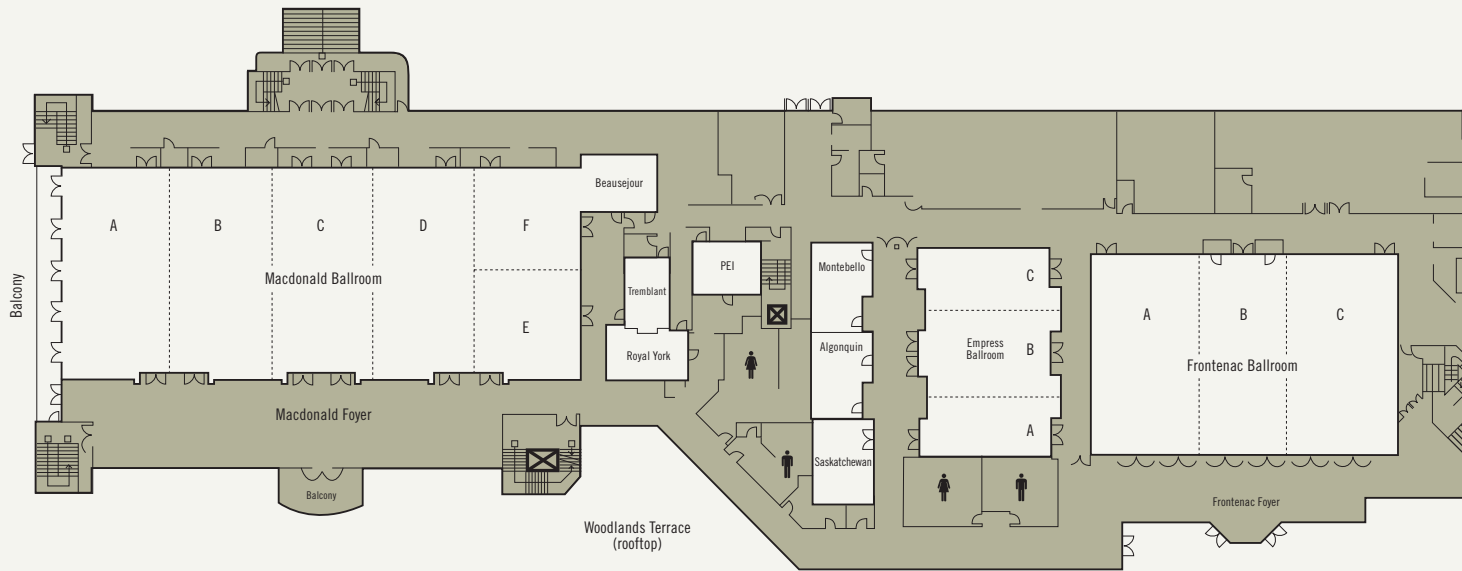

FUNCTION ROOM CAPACITIES

ROOMS	OVERALL DIMENSIONS		SQUARE		HEIGHT		CAPACITIES					
	METRES	FEET	METRES	FEET	METRES	FEET	THEATRE	BOARDROOM	U-SHAPE	CLASSROOM	ROUNDS OF 8	RECEPTION
Frontenac	30.85 x 19.87	101'2" x 65'2"	613	6,598'	4.72	15'6"	800	100	120	318	480	700
Frontenac A	19.87 x 11.19	65'2" x 36'8"	222.3	2,393'	4.72	15'6"	270	50	60	129	144	275
Frontenac B	19.87 x 8.47	65'2" x 27'9"	168.39	1,813'	4.72	15'6"	200	50	64	108	120	150
Frontenac C	19.87 x 11.19	65'2" x 36'8"	222.3	2,393'	4.72	15'6"	270	50	60	129	144	275
Frontenac BC/AB	19.87 x 19.66	65'2" x 64'6"	390.69	4,205'	4.72	15'6"	470	75	80	240	288	350
Frontenac Foyer	–	–	–	–	–	–	–	–	–	–	–	150
Empress	20.42 x 13.11	67' x 43'	267.65	2,881'	4.1	13'7"	340	58	69	168	230	250
Empress A	13.11 x 5.94	43' x 19'6"	77.9	839'	4.1	13'7"	80	34	36	36	50	70
Empress B	13.11 x 8.53	43' x 28'	111.86	1,204'	4.1	13'7"	120	46	48	72	72	100
Empress C	13.11 x 5.94	43' x 19'6"	77.9	839'	4.1	13'7"	80	34	36	42	50	70
Empress BC/AB	14.63 x 13.11	48' x 43'	191.75	2,064'	4.1	13'7"	180	64	66	78	122	170
Empress Foyer	–	–	–	–	–	–	–	–	–	–	–	50
Montebello	8.53 x 4.88	28' x 16'	41.62	448'	2.86	9'5"	28	22	12	18	24	35
Algonquin	8.53 x 4.88	28' x 16'	41.62	448'	2.93	9'7"	28	22	12	18	24	35
Saskatchewan	8.38 x 5.03	27'6" x 16'6"	42.18	454'	2.84	9'4"	28	26	–	–	24	35
Royal York	8.14 x 4.15	26'8" x 13'7"	33.73	363'	2.84	9'4"	–	12	–	–	–	–
Prince Edward Island	6.83 x 4.51	22'5" x 14'9"	30.8	332'	2.84	9'4"	16	18	10	10	16	25
Tremblant	6.83 x 4.42	22'5" x 14'6"	30.17	325'	3	9'10"	14	18	10	10	16	25
Beausejour	7.32 x 5.49	24' x 18'	40.13	432'	3	9'10"	20	20	14	12	16	25
Macdonald	52.27 x 20.12	171'6" x 66'	1,051.57	11,319'	4.83	15'10"	1,300	160	180	567	704	1,000
Macdonald A	20.12 x 10.36	66' x 34'	208.47	2,244'	4.83	15'10"	288	68	90	144	184	300
Macdonald B	20.12 x 10.52	66' x 34'6"	211.54	2,277'	4.83	15'10"	288	68	90	144	184	300
Macdonald C	20.12 x 10.52	66' x 34'6"	211.54	2,277'	4.83	15'10"	288	68	90	144	184	300
Macdonald D	20.12 x 10.52	66' x 34'6"	211.54	2,277'	4.83	15'10"	288	68	90	144	184	300
Macdonald E	10.06 x 10.36	33' x 34'	104.24	1,122'	4.83	15'10"	126	30	38	40	60	75
Macdonald F	10.06 x 10.36	33' x 34'	104.24	1,122'	4.83	15'10"	126	30	38	40	60	75
Macdonald Foyer	–	–	–	–	–	–	–	–	–	–	–	400
Hospitality Suites (5)	8.23 x 8.53	27' x 28'	70.23	756'	–	–	20	16	–	18	16	28
Woodlands Terrace	30.33 x 15.09	99'5" x 49'5"	457.57	4,925'	–	–	400	–	–	300	336	500



A journey as unforgettable as the destination

From rugged coastline to soaring mountain summits, getting to The Fairmont Chateau Whistler offers every opportunity to marvel at Western Canada's natural beauty. Travel the 127 kilometres (79 miles) north from Vancouver — 90 minutes by car or luxury coach — along the stunning Sea-to-Sky Highway; considered one of the most scenic drives in North America, this newly re-engineered highway now boasts safety and environmental features that have streamlined the spectacular journey. Experience the elegance and leisurely pace of an earlier age with a trip by train. Or fly by helicopter or float plane for a truly unforgettable adventure, with unparalleled views of Howe Sound and the majestic Coast Mountains.

FLYING TIMES (IN HOURS) TO VANCOUVER

Vancouver International Airport (YVR) offers convenient worldwide access through all major carriers.

ATHENS	12.5	PARIS	9
CHICAGO	4	ROME	11
DALLAS	4.5	SAN FRANCISCO	2.5
FRANKFURT	10	SINGAPORE	16
HONG KONG	13	SYDNEY	18
LONDON	8.5	TOKYO	10
LOS ANGELES	3	TORONTO	4
MIAMI	6	WASHINGTON, D.C.	6
NEW YORK	5		



THE *Fairmont*
CHATEAU WHISTLER

4599 Chateau Boulevard
Whistler, British Columbia
Canada V0N 1B4
TEL +1 604 938 8000
FAX +1 604 938 2020
E-MAIL chateauwhistlerresort@fairmont.com
fairmont.com/whistler

For reservations contact:
1 800 441 1414 or visit fairmont.com



Fairmont Hotels & Resorts has been a WWF Climate Savers partner since 2009 and has committed to reducing its emissions by 20% below 2006 levels by 2013.