

FAIRMONT CHICAGO, MILLENNIUM PARK

ROOMS	DIMENSIONS		SQUARE		HEIGHT		CAPACITIES					
	FEET	METERS	FEET	METERS	FEET	METERS	BOARD	CLASS	THEATER	RECEPTION	ROUNDS	HOLLOW SQUARE
IMPERIAL BALLROOM LEVEL (B2 LEVEL)												
Imperial Ballroom	100 x 161	31 x 49	16,100	1,489	20	6.1	-	950	2,000	2,000	1,250	-
Regal Room	26 x 26	8 x 8	700	63	12	3.7	25	24	60	60	50	-
Royal Room	26 x 21	8 x 6	550	51	12	3.7	25	24	60	60	50	-
Imperial Parlor	39 x 10	12 x 3	390	36	8	3.7	20	18	35	-	20	-
Imperial Office	10 x 30	3 x 9	300	28	8	3.7						
Imperial Ballroom Pre-Function			4,700	437								
LOBBY LEVEL (1ST LEVEL)												
Rouge Room	65 x 75	20 x 23	4,900	454	15 - 17	4.6 - 5.2	50	150	355	400	250	60
Cuvee Room	35 x 42	11 x 13	1,360	126	12	3.7	45	54	115	150	110	38
INTERNATIONAL BALLROOM LEVEL (2ND LEVEL)												
International Ballroom	80 x 120	24 x 37	9,600	893	13 - 17	4 - 5.2	-	540	700	1,000	700	-
Gold Room	54 x 72	17 x 22	3,850	362	12 - 14	3.7 - 4.3	60	180	275	320	280	80
State Room	36 x 45	11 x 14	1,600	151	12 - 14	3.7 - 4	40	66	120	160	110	45
Ambassador Room	36 x 34	11 x 10	1,200	114	12 - 13	3.7 - 4	30	45	85	120	50	42
Embassy Room	25 x 37	8 x 10	800	74	12	3.7	25	33	58	85	50	34
International Ballroom Pre-Function			3,500	325								
MEETING ROOM LEVEL (3RD LEVEL)												
Crystal Room	45 x 68	14 x 21	3,050	285	12 - 15	3.7 - 4.6	60	156	225	225	160	68
Regent Room	36 x 45	11 x 14	1,600	151	12 - 13	3.7 - 4	40	66	120	160	110	45
Chancellor Room	36 x 34	11 x 10	1,200	114	12 - 13	3.7 - 4	30	45	85	120	90	42
Diplomat Room	17 x 24	5 x 7	400	38	12	3.7	15	14	30	20	20	12
Crystal Room Pre-Function			2,300	214								
THE FAIRMONT FLOOR (37TH LEVEL)												
Boardroom	21 x 21	6 x 6	440	41	10	3	14					

Fairmont

CHICAGO
MILLENNIUM PARK

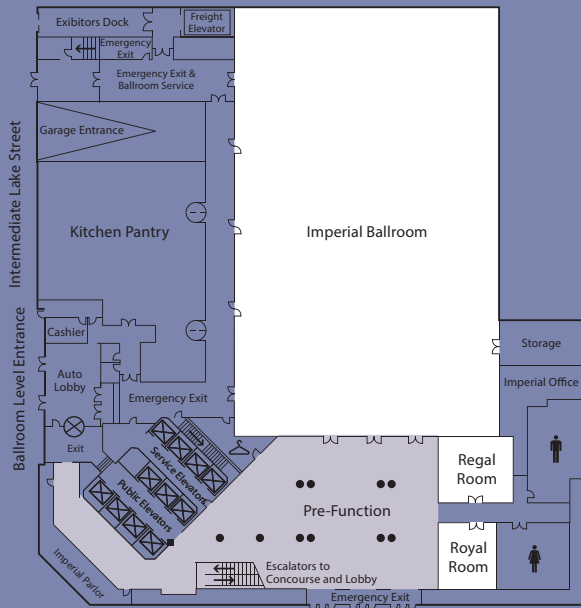

Imperial Ballroom Level - B2 Level

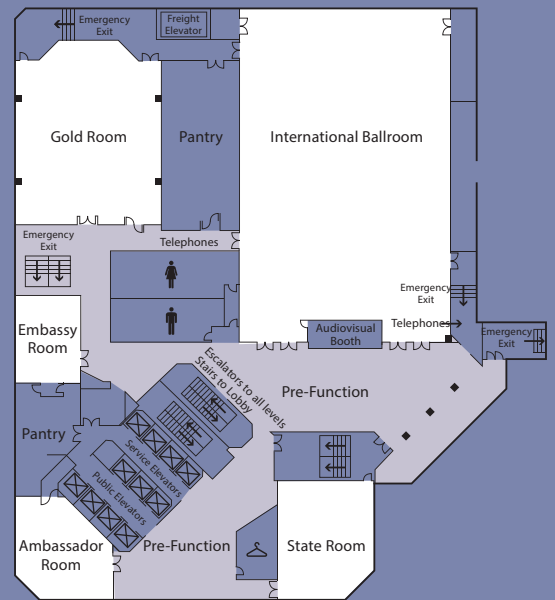

International Ballroom Level - 2nd Level

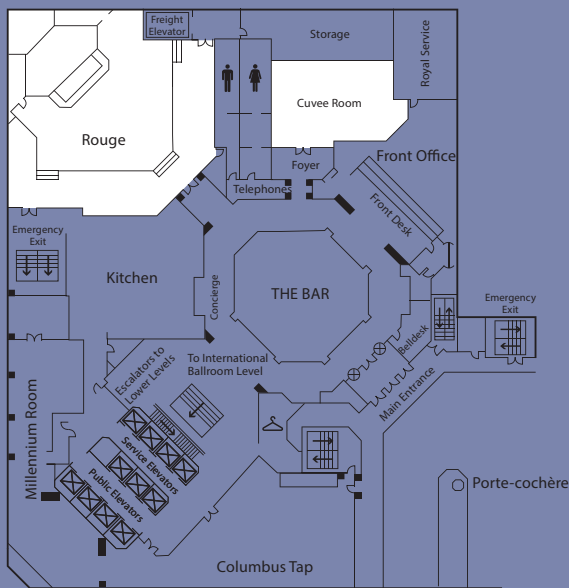

Lobby Level - 1st Level

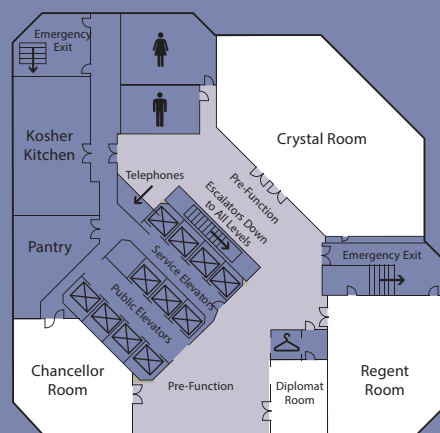

Meeting Room Level - 3rd Level